

OVERVIEW GREENSPRING



Stories	Sqft	Beds	Baths
2	2,821	4	2.5

Built in These Communities

Greene Hill Farm Estates - Smyrna, DE

The Reserve at Ponds of Odessa - Single Family Homes - Middletown, DE

About this Floor Plan

4 to 6 bedrooms, 2.5 baths, upstairs bridge overlooking the 2-story family room. Tours by appointment only—please call 302-865-0759 to schedule.

 Illustrations are artists' concepts and may vary in detail from the actual plans and specifications.

Benchmarkbuilders.com

Benchmark Builders reserves the right to change prices, plans, elevations, specifications, square footage and availability without prior notice or obligation. Renderings are for representation only and may vary from actual home. Elevations offered vary by community and square footages are approximate dependent upon elevations and/or options selected. Pricing varies by Elevation. Elevation shown may not match starting price. Please contact the New Homes Specialist for details. Not responsible for typographical errors. Benchmark Builders and the Benchmark logo are registered trademarks of Benchmark Builders, Inc. All rights reserved Effective 05/14/2026

ELEVATIONS GREENSPRING

NOTE: Images shown here represent all elevations and options for the standard floor plan, however, availability of each varies in communities offering this plan. Additional elevations not shown may be available.



Benchmarkbuilders.com

Benchmark Builders reserves the right to change prices, plans, elevations, specifications, square footage and availability without prior notice or obligation. Renderings are for representation only and may vary from actual home. Elevations offered vary by community and square footages are approximate dependent upon elevations and/or options selected. Pricing varies by Elevation. Elevation shown may not match starting price. Please contact the New Homes Specialist for details. Not responsible for typographical errors. Benchmark Builders and the Benchmark logo are registered trademarks of Benchmark Builders, Inc. All rights reserved Effective 05/14/2026

FLOOR PLANS GREENSPRING

NOTE: Images shown here represent all elevations and options for the standard floor plan, however, availability of each varies in communities offering this plan.

Details and dimensions shown are approximate and subject to change. Illustrations are artist's concepts and may vary in detail from the actual plans and specifications. The right is reserved to make changes without notice or obligation. Floor plans represent various elevations. Other elevations have walls, windows and room sizes that may vary slightly and are not shown. Please consult with the community Sales Manager for alternate floor plans, options and features.



THE GREENSPRING

First Floor

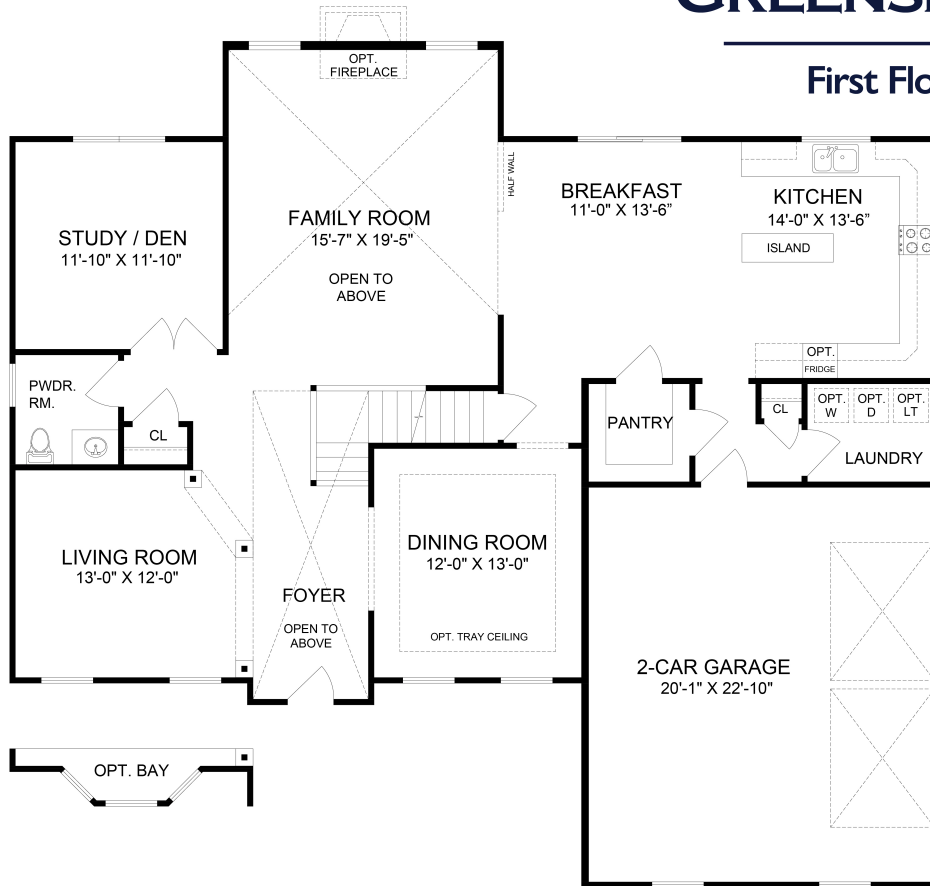

As built at Greene Hill Farm Estates

Benchmarkbuilders.com

Benchmark Builders reserves the right to change prices, plans, elevations, specifications, square footage and availability without prior notice or obligation. Renderings are for representation only and may vary from actual home. Elevations offered vary by community and square footages are approximate dependent upon elevations and/or options selected. Pricing varies by Elevation. Elevation shown may not match starting price. Please contact the New Homes Specialist for details. Not responsible for typographical errors. Benchmark Builders and the Benchmark logo are registered trademarks of Benchmark Builders, Inc. All rights reserved Effective 05/14/2026

FLOOR PLANS GREENSPRING

NOTE: Images shown here represent all elevations and options for the standard floor plan, however, availability of each varies in communities offering this plan.

Details and dimensions shown are approximate and subject to change. Illustrations are artist's concepts and may vary in detail from the actual plans and specifications. The right is reserved to make changes without notice or obligation. Floor plans represent various elevations. Other elevations have walls, windows and room sizes that may vary slightly and are not shown. Please consult with the community Sales Manager for alternate floor plans, options and features.



THE GREENSPRING

Second Floor

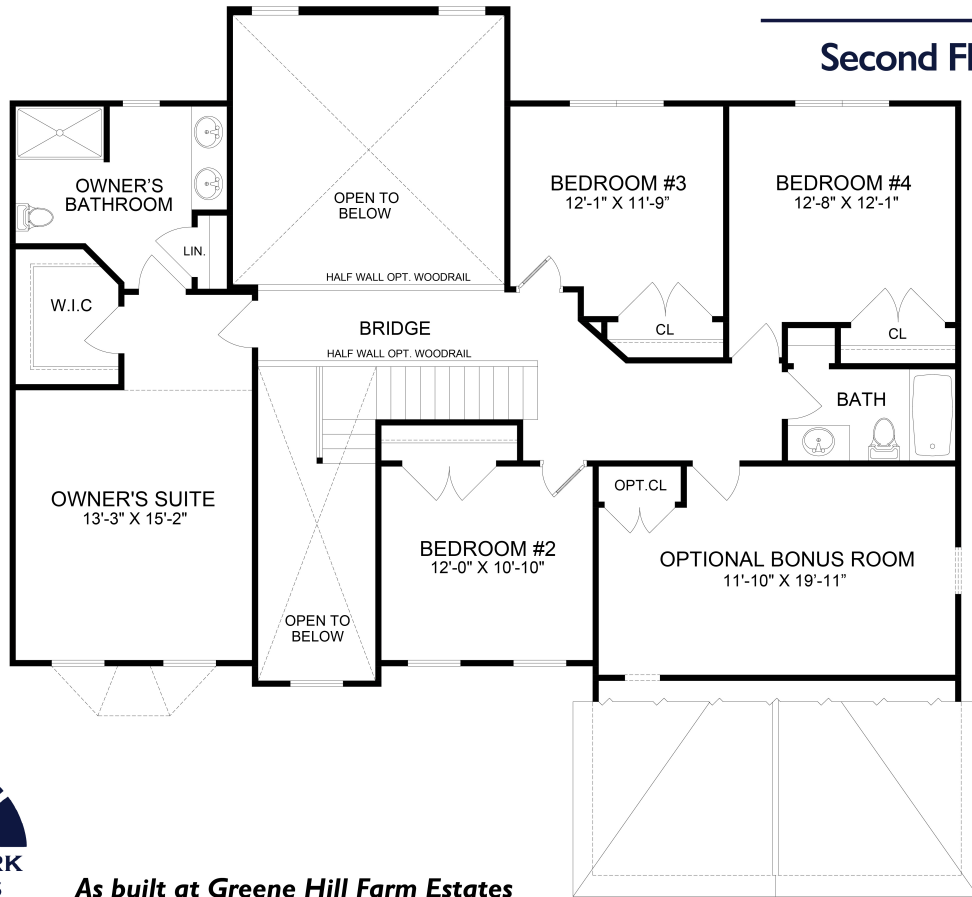

As built at Greene Hill Farm Estates

Benchmarkbuilders.com

Benchmark Builders reserves the right to change prices, plans, elevations, specifications, square footage and availability without prior notice or obligation. Renderings are for representation only and may vary from actual home. Elevations offered vary by community and square footages are approximate dependent upon elevations and/or options selected. Pricing varies by Elevation. Elevation shown may not match starting price. Please contact the New Homes Specialist for details. Not responsible for typographical errors. Benchmark Builders and the Benchmark logo are registered trademarks of Benchmark Builders, Inc. All rights reserved Effective 05/14/2026